

**SIX MONTH SURVEILLANCE
HOMOGENEOUS ACBM RECORDS**

Date of Inspection: 1/23/08

District: Chico Unified School District

Inspector: Leroy Christophersen

School: Fair View High School (FKA Partridge Elementary School)

Building: C - Classrooms 3-6 (FKA A)

Material Class	Material	Homo. Mat. #	% Asb.	Ft ² /L.F.	Location	Condition: Code & Comments	Friable Yes/No
M	9" VFT	4	1-5%	4,500 S	CLASSROOMS 3-6 AND STAFF ROOM	(1)	N
S	ACOUSTIC CEILING PLASTER	5	1-5%	5,000 S	CLASSROOMS 3-6 AND STAFF ROOM	(1)	N
M	TRANSITE PANELS	60	ASSUMED	8 PANELS	UNDER ENTRY WINDOWS, UNIT D	(1)	N/A

School: Fair View High School (FKA Partridge Elementary School)

Building: D - Restrooms & Custodial Room (FKA A)

Material Class	Material	Homo. Mat. #	% Asb.	Ft ² /L.F.	Location	Condition: Code & Comments	Friable Yes/No
S	ACOUSTIC CEILING PLASTER	5	1-5%	1,000 S	RESTROOMS, CUSTODIAL ROOMS, AND BOILER ROOM	(1)	N
T	LARGE MUD JOINT	6	ASSUMED	22 JOINTS	BOILER ROOM	(1)	N
T	SMALL MUD JOINT	7	ASSUMED	26 JOINTS	BOILER ROOM	(1)	N
S	WALL PLASTER	31	ASSUMED	400 S	RESTROOMS	(1)	N

CONDITION CODE

General Condition: (1) Good (2) Damaged (3) Significantly Damaged (25% or more)
Change in Condition: (4) No (5) Yes (If Yes, explain under comments)
Abated: (6) Repaired (7) Removed (8) Encapsulated (9) Enclosed (10) Isolated & Restricted
Miscellaneous: (11) Inaccessible, no inspection data (12) Other (Explain under comments) (13) Non-Asbestos/Not Inspected

CONSULT ORIGINAL AND SUPPLEMENTARY INSPECTION REPORTS FOR MATERIALS WITH TRACE AMOUNTS OF ASBESTOS

**SIX MONTH SURVEILLANCE
HOMOGENEOUS ACBM RECORDS**

Date of Inspection: 1/23/08

District: Chico Unified School District

Inspector: Leroy Christophersen

School: Fair View High School (FKA Partridge Elementary School)

Building: E - Classrooms 7-10 (FKA A)

Material Class	Material	Homo. Mat. #	% Asb.	Ft ² /L.F.	Location	Condition: Code & Comments	Friable Yes/No
M	9" VFT BEIGE	4	1-5%	4,500 S	CLASSROOMS 7-10, WORK ROOM AND STAFF RESTROOMS	(1)	N
S	ACOUSTIC CEILING PLASTER	5	1-5%	5,000 S	CLASSROOMS 7-10, WORK ROOM, AND STAFF RESTROOMS	(1)	N

School: Fair View High School (FKA Partridge Elementary School)

Building: G - Classrooms 11-14 (FKA B)

Material Class	Material	Homo. Mat. #	% Asb.	Ft ² /L.F.	Location	Condition: Code & Comments	Friable Yes/No
M	9" VFT	4	1-5%	4,500 S	CLASSROOMS 11-14	(1)	N
S	ACOUSTIC CEILING PLASTER	5	1-5%	5,000 S	ALL CLASSROOMS AND BOTH RESTROOMS	(1)	N N/A
S	WALL PLASTER	31	ASSUMED	1,200 S	CUSTODIAL ROOM AND RESTROOMS	(1)	N

CONDITION CODE

General Condition: (1) Good (2) Damaged (3) Significantly Damaged (25% or more)
Change in Condition: (4) No (5) Yes (If Yes, explain under comments)
Abated: (6) Repaired (7) Removed (8) Encapsulated (9) Enclosed (10) Isolated & Restricted
Miscellaneous: (11) Inaccessible, no inspection data (12) Other (Explain under comments) (13) Non-Asbestos/Not Inspected

CONSULT ORIGINAL AND SUPPLEMENTARY INSPECTION REPORTS FOR MATERIALS WITH TRACE AMOUNTS OF ASBESTOS

**SIX MONTH SURVEILLANCE
HOMOGENEOUS ACBM RECORDS**

Date of Inspection: 1/23/08

District: Chico Unified School District

Inspector: Leroy Christophersen

School: Fair View High School (FKA Partridge Elementary School)

Building: F - MPR (911) (FKA C)

Material Class	Material	Homo. Mat. #	% Asb.	Ft ² /L.F.	Location	Condition: Code & Comments	Friable Yes/No
T	PIPE WRAP STRAIGHT	3	70-75%	150 L	KITCHEN, WATER HEATER ROOM, MPR STORAGE, AND CUSTODIAL ROOM	(1)	N
M	9" VFT	4	1-5%	6,000 S	MPR, KITCHEN, AND ADMINISTRATION	(1)	N
S	ACOUSTIC CEILING PLASTER	5	1-5%	1,400 S	HALLWAY OUTSIDE MPR	(1)	N
T	MUD JOINT	7	ASSUMED	20 JOINTS	KITCHEN, WATER HEATER ROOM, MPR STORAGE, AND CUSTODIAL ROOM	(1)	N
M	12" ACT	30	ASSUMED	UNDETERMINED	MPR	(1)	N
M	TRANSITE PIPE	99	ASSUMED	6 L	KITCHEN WATER HEATER ROOM	(1)	N

CONDITION CODE

General Condition: (1) Good (2) Damaged (3) Significantly Damaged (25% or more)
Change in Condition: (4) No (5) Yes (If Yes, explain under comments)
Abated: (6) Repaired (7) Removed (8) Encapsulated (9) Enclosed (10) Isolated & Restricted
Miscellaneous: (11) Inaccessible, no inspection data (12) Other (Explain under comments) (13) Non-Asbestos/Not Inspected

CONSULT ORIGINAL AND SUPPLEMENTARY INSPECTION REPORTS FOR MATERIALS WITH TRACE AMOUNTS OF ASBESTOS

**SIX MONTH SURVEILLANCE
HOMOGENEOUS ACBM RECORDS**

Date of Inspection: 1/23/08

District: Chico Unified School District

Inspector: Leroy Christophersen

School: Fair View High School (FKA Partridge Elementary School)

Building: H - Classroom 17 (FKA D)

Material Class	Material	Homo. Mat. #	% Asb.	Ft ² /L.F.	Location	Condition: Code & Comments	Friable Yes/No
M	LINOLEUM BEIGE	10	NONE DETECTED	100 S	GIRL'S & BOY'S RESTROOMS		N/A
M	DRYWALL & JOINT COMPOUND	32	ASSUMED	1,800 S	CLASSROOM 17 AND GIRL'S & BOY'S RESTROOMS	(1)	N
M	2' X 4' FCP'S	65	NONE DETECTED	900 S	CLASSROOM 17		N/A
M	12" VFT CREAM	103	ASSUMED	120 S	CLASSROOM 17	(1)	N
M	12" VFT CREAM	103	ASSUMED	600 S	CLASSROOM 17	(1)	N

CONDITION CODE

General Condition: (1) Good (2) Damaged (3) Significantly Damaged (25% or more)
Change in Condition: (4) No (5) Yes (If Yes, explain under comments)
Abated: (6) Repaired (7) Removed (8) Encapsulated (9) Enclosed (10) Isolated & Restricted
Miscellaneous: (11) Inaccessible, no inspection data (12) Other (Explain under comments) (13) Non-Asbestos/Not Inspected

CONSULT ORIGINAL AND SUPPLEMENTARY INSPECTION REPORTS FOR MATERIALS WITH TRACE AMOUNTS OF ASBESTOS

**SIX MONTH SURVEILLANCE
HOMOGENEOUS ACBM RECORDS**

Date of Inspection: 1/23/08

District: Chico Unified School District

Inspector: Leroy Christophersen

School: Fair View High School (FKA Partridge Elementary School)

Building: I (FKA D)

Material Class	Material	Homo. Mat. #	% Asb.	Ft ² /L.F.	Location	Condition: Code & Comments	Friable Yes/No
M	DRYWALL & JOINT COMPOUND	32	ASSUMED	2,500 S	ROOMS 15 & 16	(1)	N
M	2' X 4' FCP'S	65	NONE DETECTED	1,800 S	ROOMS 15 & 16		N/A
M	12" VFT CREAM	103	ASSUMED	240 S	ROOMS 15 & 16	(1)	N

CONDITION CODE

General Condition: (1) Good (2) Damaged (3) Significantly Damaged (25% or more)
 Change in Condition: (4) No (5) Yes (If Yes, explain under comments)
 Abated: (6) Repaired (7) Removed (8) Encapsulated (9) Enclosed (10) Isolated & Restricted
 Miscellaneous: (11) Inaccessible, no inspection data (12) Other (Explain under comments) (13) Non-Asbestos/Not Inspected

CONSULT ORIGINAL AND SUPPLEMENTARY INSPECTION REPORTS FOR MATERIALS WITH TRACE AMOUNTS OF ASBESTOS

**SIX MONTH SURVEILLANCE
HOMOGENEOUS ACBM RECORDS**

Date of Inspection: 1/23/08

District: Chico Unified School District

Inspector: Leroy Christophersen

School: Fair View High School (FKA Partridge Elementary School)

Building: J (FKA D)

Material Class	Material	Homo. Mat. #	% Asb.	Ft ² /L.F.	Location	Condition: Code & Comments	Friable Yes/No
M	2' X 8' ACT WOOD	50	NON-SUSPECT	480 S	SFA TRAILER (916) AND SPEECH TRAILER		N/A
M	2' X 4' FCP'S	65	NONE DETECTED	900 S	LIBRARY/COMPUTER ROOM (917)		N/A
M	DRYWALL	66	NONE DETECTED	400 S	COMPUTER ROOM (917)		N/A

School: Fair View High School (FKA Partridge Elementary School)

Building: K - Portables 18 & 19

Material Class	Material	Homo. Mat. #	% Asb.	Ft ² /L.F.	Location	Condition: Code & Comments	Friable Yes/No
M	DRYWALL & JOINT COMPOUND	32	ASSUMED	2,500 S	PORTABLES 18 & 19	(1)	N
M	12" VFT	51	ASSUMED	300 S	PORTABLES 18 & 19	(1)	N
M	2' X 4' FCP'S	52	ASSUMED	1,800 S	PORTABLES 18 & 19	(1)	N

CONDITION CODE

General Condition: (1) Good (2) Damaged (3) Significantly Damaged (25% or more)
Change in Condition: (4) No (5) Yes (If Yes, explain under comments)
Abated: (6) Repaired (7) Removed (8) Encapsulated (9) Enclosed (10) Isolated & Restricted
Miscellaneous: (11) Inaccessible, no inspection data (12) Other (Explain under comments) (13) Non-Asbestos/Not Inspected

CONSULT ORIGINAL AND SUPPLEMENTARY INSPECTION REPORTS FOR MATERIALS WITH TRACE AMOUNTS OF ASBESTOS

**SIX MONTH SURVEILLANCE
HOMOGENEOUS ACBM RECORDS**

Date of Inspection: 1/23/08

District: Chico Unified School District

Inspector: Leroy Christophersen

School: Fair View High School (FKA Partridge Elementary School)

Building: A - Unit 1

Material Class	Material	Homo. Mat. #	% Asb.	Ft ² /L.F.	Location	Condition: Code & Comments	Friable Yes/No
M	2' X 4' FCP'S	53	ASSUMED	900 S	PORTABLE 1	(1)	N
M	12" VFT CREAM	61	ASSUMED	300 S	PORTABLE 1 - EAST SIDE	(1)	N
M	12" VFT CREAM	90	ASSUMED	600 S	PORTABLE 1 - WEST SIDE	(1)	N
M	LINOLEUM TAN	100	ASSUMED	60 S	LAUNDRY AND GIRL'S & BOY'S RESTROOMS	(1)	N
M	GYPSUM BOARD	101	ASSUMED	300 S	LAUNDRY AND GIRL'S & BOY'S RESTROOMS	(1)	N
M	GYPSUM BOARD	101	ASSUMED	2,000 S	PORTABLE 1	(1)	N

CONDITION CODE

General Condition: (1) Good (2) Damaged (3) Significantly Damaged (25% or more)
 Change in Condition: (4) No (5) Yes (If Yes, explain under comments)
 Abated: (6) Repaired (7) Removed (8) Encapsulated (9) Enclosed (10) Isolated & Restricted
 Miscellaneous: (11) Inaccessible, no inspection data (12) Other (Explain under comments) (13) Non-Asbestos/Not Inspected

CONSULT ORIGINAL AND SUPPLEMENTARY INSPECTION REPORTS FOR MATERIALS WITH TRACE AMOUNTS OF ASBESTOS

**SIX MONTH SURVEILLANCE
HOMOGENEOUS ACBM RECORDS**

Date of Inspection: 1/23/08

District: Chico Unified School District

Inspector: Leroy Christophersen

School: Fair View High School (FKA Partridge Elementary School)

Building: B - Portable 2

Material Class	Material	Homo. Mat. #	% Asb.	Ft ² /L.F.	Location	Condition: Code & Comments	Friable Yes/No
S	ACOUSTIC CEILING PLASTER	5	ASSUMED	1,000 S	ROOM 2 - UNIT B	(1)	N
S	WALL PLASTER	31	ASSUMED	UNDETERMINED	PORTABLE 2	(1)	N
M	2' X 4' FCP'S	55	ASSUMED	600 S	PORTABLE 2	(1)	N/A
M	9" VFT GREEN	63	ASSUMED	200 S	PORTABLE 2	(1)	N

School: Fair View High School (FKA Partridge Elementary School)

Building: L - Portable 20

Material Class	Material	Homo. Mat. #	% Asb.	Ft ² /L.F.	Location	Condition: Code & Comments	Friable Yes/No
M	DRYWALL & JOINT COMPOUND	32	ASSUMED	1,250 S	PORTABLE 20	(1)	N
M	2' X 4' FCP'S FIBERGLASS	54	NON-SUSPECT	600 S	PORTABLE 20		N/A
M	12" VFT WHITE	62	ASSUMED	900 S	PORTABLE 20	(1)	N

CONDITION CODE

General Condition: (1) Good (2) Damaged (3) Significantly Damaged (25% or more)
 Change in Condition: (4) No (5) Yes (If Yes, explain under comments)
 Abated: (6) Repaired (7) Removed (8) Encapsulated (9) Enclosed (10) Isolated & Restricted
 Miscellaneous: (11) Inaccessible, no inspection data (12) Other (Explain under comments) (13) Non-Asbestos/Not Inspected

CONSULT ORIGINAL AND SUPPLEMENTARY INSPECTION REPORTS FOR MATERIALS WITH TRACE AMOUNTS OF ASBESTOS

**SIX MONTH SURVEILLANCE
HOMOGENEOUS ACBM RECORDS**

Date of Inspection: 07/17/2008

District: Chico Unified School District

Inspector: Leroy Christophersen

School: Fair View High School (FKA Partridge Elementary School)

Building: C - Classrooms 3-6 (FKA A)

Material Class	Material	Homo. Mat. #	% Asb.	Ft ² /L.F.	Location	Condition: Code & Comments	Friable Yes/No
M	9" VFT	4	1-5%	4,500 S	CLASSROOMS 3-6 AND STAFF ROOM	(1)	N
S	ACOUSTIC CEILING PLASTER	5	1-5%	5,000 S	CLASSROOMS 3-6 AND STAFF ROOM	(1)	N
M	TRANSITE PANELS	60	ASSUMED	8 PANELS	UNDER ENTRY WINDOWS, UNIT D	(1)	N/A

School: Fair View High School (FKA Partridge Elementary School)

Building: D - Restrooms & Custodial Room (FKA A)

Material Class	Material	Homo. Mat. #	% Asb.	Ft ² /L.F.	Location	Condition: Code & Comments	Friable Yes/No
S	ACOUSTIC CEILING PLASTER	5	1-5%	1,000 S	RESTROOMS, CUSTODIAL ROOMS, AND BOILER ROOM	(1)	N
T	LARGE MUD JOINT	6	ASSUMED	22 JOINTS	BOILER ROOM	(1)	N
T	SMALL MUD JOINT	7	ASSUMED	26 JOINTS	BOILER ROOM	(1)	N
S	WALL PLASTER	31	ASSUMED	400 S	RESTROOMS	(1)	N

CONDITION CODE

General Condition: (1) Good (2) Damaged (3) Significantly Damaged (25% or more)
Change in Condition: (4) No (5) Yes (If Yes, explain under comments)
Abated: (6) Repaired (7) Removed (8) Encapsulated (9) Enclosed (10) Isolated & Restricted
Miscellaneous: (11) Inaccessible, no inspection data (12) Other (Explain under comments) (13) Non-Asbestos/Not Inspected

CONSULT ORIGINAL AND SUPPLEMENTARY INSPECTION REPORTS FOR MATERIALS WITH TRACE AMOUNTS OF ASBESTOS

**SIX MONTH SURVEILLANCE
HOMOGENEOUS ACBM RECORDS**

Date of Inspection: 07/17/2008

District: Chico Unified School District

Inspector: Leroy Christophersen

School: Fair View High School (FKA Partridge Elementary School)

Building: E - Classrooms 7-10 (FKA A)

Material Class	Material	Homo. Mat. #	% Asb.	Ft ² /L.F.	Location	Condition: Code & Comments	Friable Yes/No
M	9" VFT BEIGE	4	1-5%	4,500 S	CLASSROOMS 7-10, WORK ROOM AND STAFF RESTROOMS	(1)	N
S	ACOUSTIC CEILING PLASTER	5	1-5%	5,000 S	CLASSROOMS 7-10, WORK ROOM, AND STAFF RESTROOMS	(1)	N

School: Fair View High School (FKA Partridge Elementary School)

Building: G - Classrooms 11-14 (FKA B)

Material Class	Material	Homo. Mat. #	% Asb.	Ft ² /L.F.	Location	Condition: Code & Comments	Friable Yes/No
M	9" VFT	4	1-5%	4,500 S	CLASSROOMS 11-14	(1)	N
S	ACOUSTIC CEILING PLASTER	5	1-5%	5,000 S	ALL CLASSROOMS AND BOTH RESTROOMS	(1)	N N/A
S	WALL PLASTER	31	ASSUMED	1,200 S	CUSTODIAL ROOM AND RESTROOMS	(1)	N

CONDITION CODE

General Condition: (1) Good (2) Damaged (3) Significantly Damaged (25% or more)
Change in Condition: (4) No (5) Yes (If Yes, explain under comments)
Abated: (6) Repaired (7) Removed (8) Encapsulated (9) Enclosed (10) Isolated & Restricted
Miscellaneous: (11) Inaccessible, no inspection data (12) Other (Explain under comments) (13) Non-Asbestos/Not Inspected

CONSULT ORIGINAL AND SUPPLEMENTARY INSPECTION REPORTS FOR MATERIALS WITH TRACE AMOUNTS OF ASBESTOS

**SIX MONTH SURVEILLANCE
HOMOGENEOUS ACBM RECORDS**

Date of Inspection: 07/17/2008

District: Chico Unified School District

Inspector: Leroy Christophersen

School: Fair View High School (FKA Partridge Elementary School)

Building: F - MPR (911) (FKA C)

Material Class	Material	Homo. Mat. #	% Asb.	Ft ² /L.F.	Location	Condition: Code & Comments	Friable Yes/No
T	PIPE WRAP STRAIGHT	3	70-75%	150 L	KITCHEN, WATER HEATER ROOM, MPR STORAGE, AND CUSTODIAL ROOM	(1)	N
M	9" VFT	4	1-5%	6,000 S	MPR, KITCHEN, AND ADMINISTRATION	(1)	N
S	ACOUSTIC CEILING PLASTER	5	1-5%	1,400 S	HALLWAY OUTSIDE MPR	(1)	N
T	MUD JOINT	7	ASSUMED	20 JOINTS	KITCHEN, WATER HEATER ROOM, MPR STORAGE, AND CUSTODIAL ROOM	(1)	N
M	12" ACT	30	ASSUMED	UNDETERMINED	MPR	(1)	N
M	TRANSITE PIPE	99	ASSUMED	6 L	KITCHEN WATER HEATER ROOM	(1)	N

CONDITION CODE

General Condition: (1) Good (2) Damaged (3) Significantly Damaged (25% or more)
Change in Condition: (4) No (5) Yes (If Yes, explain under comments)
Abated: (6) Repaired (7) Removed (8) Encapsulated (9) Enclosed (10) Isolated & Restricted
Miscellaneous: (11) Inaccessible, no inspection data (12) Other (Explain under comments) (13) Non-Asbestos/Not Inspected

CONSULT ORIGINAL AND SUPPLEMENTARY INSPECTION REPORTS FOR MATERIALS WITH TRACE AMOUNTS OF ASBESTOS

**SIX MONTH SURVEILLANCE
HOMOGENEOUS ACBM RECORDS**

Date of Inspection: 07/17/2008

District: Chico Unified School District

Inspector: Leroy Christophersen

School: Fair View High School (FKA Partridge Elementary School)

Building: H - Classroom 17 (FKA D)

Material Class	Material	Homo. Mat. #	% Asb.	Ft ² /L.F.	Location	Condition: Code & Comments	Friable Yes/No
M	LINOLEUM BEIGE	10	NONE DETECTED	100 S	GIRL'S & BOY'S RESTROOMS		N/A
M	DRYWALL & JOINT COMPOUND	32	ASSUMED	1,800 S	CLASSROOM 17 AND GIRL'S & BOY'S RESTROOMS	(1)	N
M	2' X 4' FCP'S	65	NONE DETECTED	900 S	CLASSROOM 17		N/A
M	12" VFT CREAM	103	NON ASBESTOS	120 S	CLASSROOM 17	(1) MANUFACTURED IN 1987 MANUFACTURER LETTER ON FILE	N
M	12" VFT CREAM	103	ASSUMED	600 S	CLASSROOM 17	(1)	N

CONDITION CODE

General Condition: (1) Good (2) Damaged (3) Significantly Damaged (25% or more)
Change in Condition: (4) No (5) Yes (If Yes, explain under comments)
Abated: (6) Repaired (7) Removed (8) Encapsulated (9) Enclosed (10) Isolated & Restricted
Miscellaneous: (11) Inaccessible, no inspection data (12) Other (Explain under comments) (13) Non-Asbestos/Not Inspected

CONSULT ORIGINAL AND SUPPLEMENTARY INSPECTION REPORTS FOR MATERIALS WITH TRACE AMOUNTS OF ASBESTOS

**SIX MONTH SURVEILLANCE
HOMOGENEOUS ACBM RECORDS**

Date of Inspection: 07/17/2008

District: Chico Unified School District

Inspector: Leroy Christophersen

School: Fair View High School (FKA Partridge Elementary School)

Building: I (FKA D)

Material Class	Material	Homo. Mat. #	% Asb.	Ft ² /L.F.	Location	Condition: Code & Comments	Friable Yes/No
M	DRYWALL & JOINT COMPOUND	32	ASSUMED	2,500 S	ROOMS 15 & 16	(1)	N
M	2' X 4' FCP'S	65	NONE DETECTED	1,800 S	ROOMS 15 & 16		N/A
M	12" VFT CREAM	103	ASSUMED	240 S	ROOMS 15 & 16	(1)	N

CONDITION CODE

General Condition: (1) Good (2) Damaged (3) Significantly Damaged (25% or more)
 Change in Condition: (4) No (5) Yes (If Yes, explain under comments)
 Abated: (6) Repaired (7) Removed (8) Encapsulated (9) Enclosed (10) Isolated & Restricted
 Miscellaneous: (11) Inaccessible, no inspection data (12) Other (Explain under comments) (13) Non-Asbestos/Not Inspected

CONSULT ORIGINAL AND SUPPLEMENTARY INSPECTION REPORTS FOR MATERIALS WITH TRACE AMOUNTS OF ASBESTOS

**SIX MONTH SURVEILLANCE
HOMOGENEOUS ACBM RECORDS**

Date of Inspection: 07/17/2008

District: Chico Unified School District

Inspector: Leroy Christophersen

School: Fair View High School (FKA Partridge Elementary School)

Building: J (FKA D)

Material Class	Material	Homo. Mat. #	% Asb.	Ft ² /L.F.	Location	Condition: Code & Comments	Friable Yes/No
M	2' X 8' ACT WOOD	50	NON-SUSPECT	480 S	SFA TRAILER (916) AND SPEECH TRAILER		N/A
M	2' X 4' FCP'S	65	NONE DETECTED	900 S	LIBRARY/COMPUTER ROOM (917)		N/A
M	DRYWALL	66	NONE DETECTED	400 S	COMPUTER ROOM (917)		N/A

School: Fair View High School (FKA Partridge Elementary School)

Building: K - Portables 18 & 19

Material Class	Material	Homo. Mat. #	% Asb.	Ft ² /L.F.	Location	Condition: Code & Comments	Friable Yes/No
M	DRYWALL & JOINT COMPOUND	32	ASSUMED	2,500 S	PORTABLES 18 & 19	(1)	N
M	12" VFT	51	ASSUMED	300 S	PORTABLES 18 & 19	(1)	N
M	2' X 4' FCP'S	52	ASSUMED	1,800 S	PORTABLES 18 & 19	(1)	N

CONDITION CODE

General Condition: (1) Good (2) Damaged (3) Significantly Damaged (25% or more)
Change in Condition: (4) No (5) Yes (If Yes, explain under comments)
Abated: (6) Repaired (7) Removed (8) Encapsulated (9) Enclosed (10) Isolated & Restricted
Miscellaneous: (11) Inaccessible, no inspection data (12) Other (Explain under comments) (13) Non-Asbestos/Not Inspected

CONSULT ORIGINAL AND SUPPLEMENTARY INSPECTION REPORTS FOR MATERIALS WITH TRACE AMOUNTS OF ASBESTOS

**SIX MONTH SURVEILLANCE
HOMOGENEOUS ACBM RECORDS**

Date of Inspection: 07/17/2008

District: Chico Unified School District

Inspector: Leroy Christophersen

School: Fair View High School (FKA Partridge Elementary School)

Building: A - Unit 1

Material Class	Material	Homo. Mat. #	% Asb.	Ft ² /L.F.	Location	Condition: Code & Comments	Friable Yes/No
M	2' X 4' FCP'S	53	ASSUMED	900 S	PORTABLE 1	(1)	N
M	12" VFT CREAM	61	ASSUMED	300 S	PORTABLE 1 - EAST SIDE	(1)	N
M	12" VFT CREAM	90	ASSUMED	600 S	PORTABLE 1 - WEST SIDE	(1)	N
M	LINOLEUM TAN	100	ASSUMED	60 S	LAUNDRY AND GIRL'S & BOY'S RESTROOMS	(1)	N
M	GYPSUM BOARD	101	ASSUMED	300 S	LAUNDRY AND GIRL'S & BOY'S RESTROOMS	(1)	N
M	GYPSUM BOARD	101	ASSUMED	2,000 S	PORTABLE 1	(1)	N

CONDITION CODE

General Condition: (1) Good (2) Damaged (3) Significantly Damaged (25% or more)
 Change in Condition: (4) No (5) Yes (If Yes, explain under comments)
 Abated: (6) Repaired (7) Removed (8) Encapsulated (9) Enclosed (10) Isolated & Restricted
 Miscellaneous: (11) Inaccessible, no inspection data (12) Other (Explain under comments) (13) Non-Asbestos/Not Inspected

CONSULT ORIGINAL AND SUPPLEMENTARY INSPECTION REPORTS FOR MATERIALS WITH TRACE AMOUNTS OF ASBESTOS

**SIX MONTH SURVEILLANCE
HOMOGENEOUS ACBM RECORDS**

Date of Inspection: 07/17/2008

District: Chico Unified School District

Inspector: Leroy Christophersen

School: Fair View High School (FKA Partridge Elementary School) Building: B - Portable 2

Material Class	Material	Homo. Mat. #	% Asb.	Ft ² /L.F.	Location	Condition: Code & Comments	Friable Yes/No
S	ACOUSTIC CEILING PLASTER	5	ASSUMED	1,000 S	ROOM 2 - UNIT B	(1) MANUFACTURED IN 1997	N
S	WALL PLASTER	31	ASSUMED	UNDETERMINED	PORTABLE 2	(1)	N
M	2' X 4' FCP'S	55	ASSUMED	600 S	PORTABLE 2	(1)	N/A
M	9" VFT GREEN	63	CERTIFIED NON ASBESTOS	200 S	PORTABLE 2	(1) MANUFACTURER LETTER ON FILE	N

School: Fair View High School (FKA Partridge Elementary School) Building: L - Portable 20

Material Class	Material	Homo. Mat. #	% Asb.	Ft ² /L.F.	Location	Condition: Code & Comments	Friable Yes/No
M	DRYWALL & JOINT COMPOUND	32	ASSUMED	1,250 S	PORTABLE 20	(1)	N
M	2' X 4' FCP'S FIBERGLASS	54	NON-SUSPECT	600 S	PORTABLE 20		N/A
M	12" VFT WHITE	62	ASSUMED	900 S	PORTABLE 20	(1)	N

CONDITION CODE

General Condition: (1) Good (2) Damaged (3) Significantly Damaged (25% or more)
 Change in Condition: (4) No (5) Yes (If Yes, explain under comments)
 Abated: (6) Repaired (7) Removed (8) Encapsulated (9) Enclosed (10) Isolated & Restricted
 Miscellaneous: (11) Inaccessible, no inspection data (12) Other (Explain under comments) (13) Non-Asbestos/Not Inspected

CONSULT ORIGINAL AND SUPPLEMENTARY INSPECTION REPORTS FOR MATERIALS WITH TRACE AMOUNTS OF ASBESTOS



Bulk Asbestos Analysis

(EPA Method 600/R-93-116, Visual Area Estimation)

Chico Unified School Dist
Leroy Christophersen

2455 Carmichael Drive
Chico, CA 95928

Client ID: 2921
Report Number: B116650
Date Received: 09/03/08
Date Analyzed: 09/04/08
Date Printed: 09/04/08
First Reported: 09/04/08

Job ID/Site: Fascia/Overhang - Fair View High School - Unit C / Room 3

FASI Job ID: 2921

Date(s) Collected: 09/02/2008

Total Samples Submitted: 1

Total Samples Analyzed: 1

Sample ID	Lab Number	Asbestos Type	Percent in Layer	Asbestos Type	Percent in Layer	Asbestos Type	Percent in Layer
FV01	10794173						
Layer: Grey Cementitious Material				ND			
Layer: White Cementitious Material				ND			
Layer: Paint				ND			
Total Composite Values of Fibrous Components:		Asbestos (ND)					
Cellulose (Trace)							

James Flores, Laboratory Supervisor, Hayward Laboratory

Note: Limit of Quantification ('LOQ') = 1%. 'Trace' denotes the presence of asbestos below the LOQ. 'ND' = 'None Detected'.

Analytical results and reports are generated by Forensic Analytical at the request of and for the exclusive use of the person or entity (client) named on such report. Results, reports or copies of same will not be released by Forensic Analytical to any third party without prior written request from client. This report applies only to the sample(s) tested. Supporting laboratory documentation is available upon request. This report must not be reproduced except in full, unless approved by Forensic Analytical. The client is solely responsible for the use and interpretation of test results and reports requested from Forensic Analytical. This report must not be used by the client to claim product endorsement by NVLAP or any other agency of the U.S. Government. Forensic Analytical is not able to assess the degree of hazard resulting from materials analyzed. Forensic Analytical reserves the right to dispose of all samples after a period of thirty (30) days, according to all state and federal guidelines, unless otherwise specified. All samples were received in acceptable condition unless otherwise noted.



Administrative Offices
1163 E. Seventh Street
Chico, CA 95928-5999

530/898-3000
fax 891-3220
www.cusd.chico.k12.ca.us

Maintenance/Operations/Facilities • 2455 Carmichael Drive • Chico, CA 95928 • (530) 891-3195 • Fax: (530) 891-3190

Fed Ex Airbill #8527 7025 2074

September 2, 2008

Forensic Analytical Specialties, Inc.
3777 Depot Road, Suite 409
Hayward, CA 94545

Re: Fair View High School

To Whom It May Concern:

Please test the enclosed sample from Fair View High School for asbestos. We would like a 24-hour turnaround on the sample. Please e-mail the results as soon as they are available to lchristo@chicousd.org.

Site Sampled:	Fair View High School
Location:	Unit C / Room 3
Date Sampled:	September 2, 2008
Number of Samples:	(1) #FV01

Thank you for your prompt response to this request.

Sincerely,

Leroy Christophersen
Safety & Loss Coordinator

Enclosure (1)
dlg

AJG F1030

RECEIVED SEP 03 2008



Client Name & Address: Chico Unified School District 2455 Carmichael Drive Chico, CA 95928		P.O. #: 080332 Date: 9/2/08
Contact: Leroy Christophersen Phone #: 530-891-3195 Fax#: (530) 891-3190		Turn Around Time: 24 hr / 12hr (24hr) 48 hr / ext: _____ Due Date: / / Due Time: : am/pm <input checked="" type="checkbox"/> PLM: <input checked="" type="checkbox"/> Standard / <input type="checkbox"/> Point Count <input type="checkbox"/> PCM: NIOSH 7400
Site: Fairview High Job: Fascia/overhang		<input type="checkbox"/> TEM Air: <input type="checkbox"/> AHERA / <input type="checkbox"/> Yamate2 / <input type="checkbox"/> NIOSH 7402 <input type="checkbox"/> TEM Bulk: <input type="checkbox"/> Quantitative / <input type="checkbox"/> Qualitative / <input type="checkbox"/> Chatfield <input type="checkbox"/> TEM Water: <input type="checkbox"/> Potable / <input type="checkbox"/> Non-Potable / <input type="checkbox"/> Wt % <input type="checkbox"/> TEM Microvac <input type="checkbox"/> Special Project: <input type="checkbox"/> Metals Analysis: Method _____ Matrix: _____ Analytes: _____

Comments:

Sample ID	Date/Time	Sample Location/Description	FOR AIR SAMPLES ONLY				Sample Area or Air Volume
			Type	Time On/Off	Avg. LPM	Total Time	
FV01	9/2/08	Unit C - overhang gray/concrete	A P C				
			A P C				
			A P C				
			A P C				
			A P C				
			A P C				
			A P C				
			A P C				

Sampled by: Kip Hansen Date: 9/2/08 Time: 9:30am
 Shipped via: Fed Ex Airborne UPS US Mail Courier Drop Off Other:

Relinquished by: Date / Time:	Relinquished by: Date / Time:	Relinquished by: Date / Time:
Received by: <u>AG</u> Date / Time: <u>7:00</u> RECEIVED SEP 03 2008	Received by: Date / Time:	Received by: Date / Time:
Condition Acceptable? <input type="checkbox"/> Yes <input type="checkbox"/> No	Condition Acceptable? <input type="checkbox"/> Yes <input type="checkbox"/> No	Condition Acceptable? <input type="checkbox"/> Yes <input type="checkbox"/> No

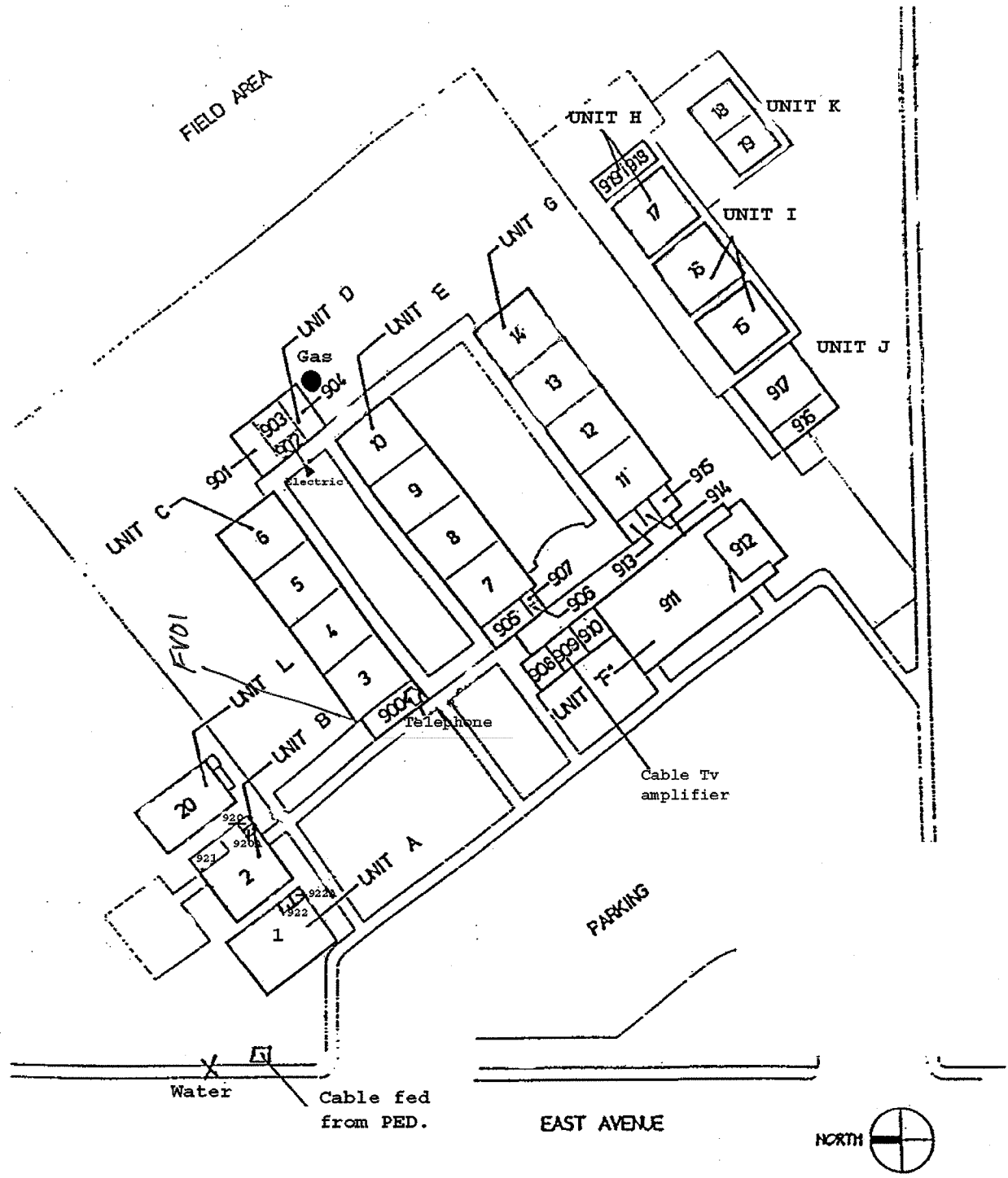

FAIR VIEW HIGH SCHOOL
 (at Jay Partridge site)

Updated 9/2006



Bulk Asbestos Analysis

(EPA Method 600/R-93-116, Visual Area Estimation)

Chico Unified School Dist
Leroy Christophersen

2455 Carmichael Drive
Chico, CA 95928

Client ID: 2921
Report Number: B117261
Date Received: 09/19/08
Date Analyzed: 09/23/08
Date Printed: 09/23/08
First Reported: 09/23/08

Job ID/Site: Roof Unit C - Fair View High School - Fair View

FASI Job ID: 2921

Date(s) Collected: 09/18/2008

Total Samples Submitted: 7

Total Samples Analyzed: 7

Sample ID	Lab Number	Asbestos Type	Percent in Layer	Asbestos Type	Percent in Layer	Asbestos Type	Percent in Layer
FV01	10800061						
Layer: Black Tar Stones			ND				
Layer: Black Felt			ND				
Layer: Black Tar			ND				
Layer: Black Felt			ND				
Layer: Black Tar			ND				
Layer: Black Felt			ND				
Layer: Black Tar			ND				
Layer: Black Felt			ND				
Total Composite Values of Fibrous Components:		Asbestos (ND)					
Fibrous Glass (50 %)							
Comment: Bulk complex sample.							
FV02	10800062						
Layer: Stones			ND				
Layer: Black Tar			ND				
Layer: Black Felt			ND				
Total Composite Values of Fibrous Components:		Asbestos (ND)					
Fibrous Glass (45 %)							
FV03	10800063						
Layer: Black Tar Stones			ND				
Layer: Black Felt			ND				
Layer: Black Tar			ND				
Layer: Black Felt			ND				
Layer: Black Tar			ND				
Layer: Black Felt			ND				
Layer: Black Tar			ND				
Layer: Black Felt			ND				
Total Composite Values of Fibrous Components:		Asbestos (ND)					
Fibrous Glass (50 %)							
Comment: Bulk complex sample.							

Client Name: Chico Unified School Dist

Report Number: B117261

Date Printed: 09/23/08

Sample ID	Lab Number	Asbestos Type	Percent in Layer	Asbestos Type	Percent in Layer	Asbestos Type	Percent in Layer
FV04	10800064						
Layer: Black Tar Stones			ND				
Layer: Black Felt			ND				
Layer: Black Tar			ND				
Layer: Black Felt			ND				
Layer: Black Tar			ND				
Layer: Black Felt			ND				
Layer: Black Tar			ND				
Layer: Black Felt			ND				
Total Composite Values of Fibrous Components:		Asbestos (ND)					
Fibrous Glass (50 %)							
Comment: Bulk complex sample.							
FV05	10800065						
Layer: Black Tar Stones			ND				
Layer: Black Felt			ND				
Layer: Black Tar			ND				
Layer: Black Felt			ND				
Layer: Black Tar			ND				
Layer: Black Felt			ND				
Layer: Black Tar			ND				
Layer: Black Felt			ND				
Total Composite Values of Fibrous Components:		Asbestos (ND)					
Fibrous Glass (50 %)							
Comment: Bulk complex sample.							
FV06	10800066						
Layer: Black Tar Stones			ND				
Layer: Black Felt			ND				
Layer: Black Tar			ND				
Layer: Black Felt			ND				
Layer: Black Tar			ND				
Layer: Black Felt			ND				
Layer: Black Tar			ND				
Layer: Black Felt			ND				
Total Composite Values of Fibrous Components:		Asbestos (ND)					
Fibrous Glass (50 %)							
Comment: Bulk complex sample.							

Client Name: Chico Unified School Dist

Report Number: B117261

Date Printed: 09/23/08

Sample ID	Lab Number	Asbestos Type	Percent in Layer	Asbestos Type	Percent in Layer	Asbestos Type	Percent in Layer
FV07	10800067						
Layer: Black Tar Stones			ND				
Layer: Black Felt			ND				
Layer: Black Tar			ND				
Layer: Black Felt			ND				
Layer: Black Tar			ND				
Layer: Black Felt			ND				
Layer: Black Tar			ND				
Layer: Black Felt			ND				
Total Composite Values of Fibrous Components:		Asbestos (ND)					
Fibrous Glass (50 %)							
Comment: Bulk complex sample.							



James Flores, Laboratory Supervisor, Hayward Laboratory

Note: Limit of Quantification ('LOQ') = 1%. 'Trace' denotes the presence of asbestos below the LOQ. 'ND' = 'None Detected'.

Analytical results and reports are generated by Forensic Analytical at the request of and for the exclusive use of the person or entity (client) named on such report. Results, reports or copies of same will not be released by Forensic Analytical to any third party without prior written request from client. This report applies only to the sample(s) tested. Supporting laboratory documentation is available upon request. This report must not be reproduced except in full, unless approved by Forensic Analytical. The client is solely responsible for the use and interpretation of test results and reports requested from Forensic Analytical. This report must not be used by the client to claim product endorsement by NVLAP or any other agency of the U.S. Government. Forensic Analytical is not able to assess the degree of hazard resulting from materials analyzed. Forensic Analytical reserves the right to dispose of all samples after a period of thirty (30) days, according to all state and federal guidelines, unless otherwise specified. All samples were received in acceptable condition unless otherwise noted.



Forensic Analytical

Analysis Request Form

Client Name & Address: Chico Unified School District 2455 Carmichael Drive Chico, CA 95928		P.O. #: 080332	Date: 9/18/08
Contact: Leroy Christophersen		Turn Around Time: _____ hr/ 12hr / 24hr / <u>48 hr</u> / ext: _____	Due Date: / / Due Time: : am/pm
Phone #: 530-891-3195		<input checked="" type="checkbox"/> PLM: <input checked="" type="checkbox"/> Standard / <input type="checkbox"/> Point Count <input type="checkbox"/> PCM: NIOSH 7400	<input type="checkbox"/> TEM Air: <input type="checkbox"/> AHERA / <input type="checkbox"/> Yamate2 / <input type="checkbox"/> NIOSH 7402
Fax#: (530) 891-3190		<input type="checkbox"/> TEM Bulk: <input type="checkbox"/> Quantitative / <input type="checkbox"/> Qualitative / <input type="checkbox"/> Chatfield	<input type="checkbox"/> TEM Water: <input type="checkbox"/> Potable / <input type="checkbox"/> Non-Potable / <input type="checkbox"/> Wt %
Site: Fairview		<input type="checkbox"/> TEM Microvac	<input type="checkbox"/> Special Project:
Job: Roof Unit C		<input type="checkbox"/> Metals Analysis: Method _____	Matrix: _____
Comments:			

Sample ID	Date/Time	Sample Location/Description	FOR AIR SAMPLES ONLY				Sample Area or Air Volume
			Type	Time On/Off	Avg. LPM	Total Time	
FV01	9/18/08	Roofing material	A P C				
			A P C				
			A P C				
			A P C				
			A P C				
			A P C				
FV07			A P C				
			A P C				
			A P C				

Sampled by: Leroy C Date: 9/18/08 Time: 2 : 26 PM

Shipped via: Fed Ex Airborne UPS US Mail Courier Drop Off Other:

Relinquished by:	Relinquished by:	Relinquished by:
Date / Time:	Date / Time:	Date / Time:
Received by: AIG FV030 RECEIVED SEP 19 2008	Received by:	Received by:
Date / Time:	Date / Time:	Date / Time:
Condition Acceptable? <input type="checkbox"/> Yes <input type="checkbox"/> No	Condition Acceptable? <input type="checkbox"/> Yes <input type="checkbox"/> No	Condition Acceptable? <input type="checkbox"/> Yes <input type="checkbox"/> No



Administrative Offices
1163 E. Seventh Street
Chico, CA 95928-5999

530/898-3000
fax 891-3220
www.cusd.chico.k12.ca.us

Maintenance/Operations/Facilities • 2455 Carmichael Drive • Chico, CA 95928 • (530) 891-3195 • Fax: (530) 891-3190

Fed Ex Airbill #8527 7025 2063

September 18 2008

Forensic Analytical Specialties, Inc.
3777 Depot Road, Suite 409
Hayward, CA 94545

Re: Fair View High School

To Whom It May Concern:

Please test the enclosed samples from Fair View High School for asbestos. We would like a 48-hour turnaround on the samples. Please e-mail the results as soon as they are available to lchristo@chicousd.org.

Site Sampled:	Fair View High School
Location:	Unit C Roof
Date Sampled:	September 18, 2008
Number of Samples:	Seven (7) #FV01 – FV07

Thank you for your prompt response to this request.

Sincerely,

Leroy Christophersen
Safety & Loss Coordinator

Enclosures (7)
dlg

F1030

AJG RECEIVED SEP 19 2008

RECEIVED SEP 19 2008

AG FORD

Updated 9/2006

(at Jay Partridge site)

FAIR VIEW HIGH SCHOOL



EAST AVENUE

Cable fed from PED.

Water

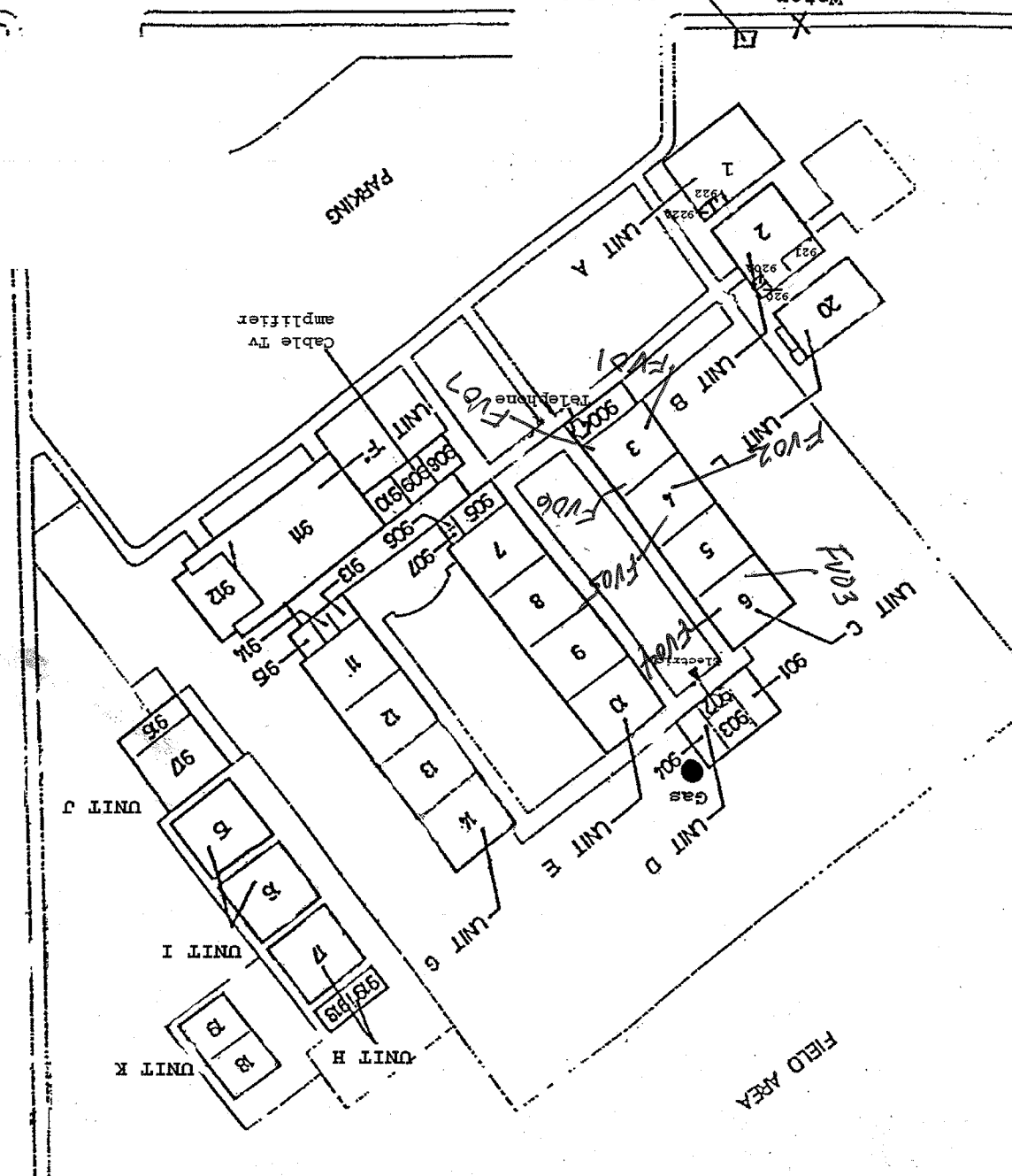



Bulk Asbestos Analysis

(EPA Method 600/R-93-116, Visual Area Estimation)

Chico Unified School Dist
Leroy Christophersen

2455 Carmichael Drive
Chico, CA 95928

Client ID: 2921
Report Number: B119770
Date Received: 12/11/08
Date Analyzed: 12/15/08
Date Printed: 12/15/08
First Reported: 12/15/08

Job ID/Site: Kitchen - Fairview High

FASI Job ID: 2921

Date(s) Collected: 12/09/2008

Total Samples Submitted: 1

Total Samples Analyzed: 1

Sample ID	Lab Number	Asbestos Type	Percent in Layer	Asbestos Type	Percent in Layer	Asbestos Type	Percent in Layer
FV01	10825042						
Layer: Off-White Plaster			ND				
Layer: White Plaster			ND				
Layer: Paint			ND				
Total Composite Values of Fibrous Components:		Asbestos (ND)					
Cellulose (Trace)							

James Flores, Laboratory Supervisor, Hayward Laboratory

Note: Limit of Quantification ('LOQ') = 1%. 'Trace' denotes the presence of asbestos below the LOQ. 'ND' = 'None Detected'.

Analytical results and reports are generated by Forensic Analytical at the request of and for the exclusive use of the person or entity (client) named on such report. Results reports or copies of same will not be released by Forensic Analytical to any third party without prior written request from client. This report applies only to the sample(s) tested. Supporting laboratory documentation is available upon request. This report must not be reproduced except in full, unless approved by Forensic Analytical. The client is solely responsible for the use and interpretation of test results and reports requested from Forensic Analytical. This report must not be used by the client to claim product endorsement by NVLAP or any other agency of the U.S. Government. Forensic Analytical is not able to assess the degree of hazard resulting from materials analyzed. Forensic Analytical reserves the right to dispose of all samples after a period of thirty (30) days, according to all state and federal guidelines, unless otherwise specified. All samples were received in acceptable condition unless otherwise noted.



Forensic Analytical

Analysis Request Form

Client Name & Address: <u>Chico Unified School District</u> <u>2455 Carmichael Drive</u> <u>Chico, CA 95928</u>		P.O. #: <u>080332</u>	Date: <u>12/9/08</u>
Contact: <u>Leroy Christophersen</u>		Turn Around Time: _____ hr/ 12hr / 24hr / <u>48 hr</u> ext: _____	Due Date: / / Due Time: : am/pm
Phone #: <u>530-891-3195</u>	Fax #: <u>(530) 891-3190</u>	<input checked="" type="checkbox"/> PLM: <input checked="" type="checkbox"/> Standard / <input type="checkbox"/> Point Count	<input type="checkbox"/> PCM: NIOSH 7400
Site: <u>Fairview High</u>	Job: <u>Kitchen</u>	<input type="checkbox"/> TEM Air: <input type="checkbox"/> AHERA / <input type="checkbox"/> Yamate2 / <input type="checkbox"/> NIOSH 7402 <input type="checkbox"/> TEM Bulk: <input type="checkbox"/> Quantitative / <input type="checkbox"/> Qualitative / <input type="checkbox"/> Chatfield <input type="checkbox"/> TEM Water: <input type="checkbox"/> Potable / <input type="checkbox"/> Non-Potable / <input type="checkbox"/> Wt % <input type="checkbox"/> TEM Microvac <input type="checkbox"/> Special Project: _____ <input type="checkbox"/> Metals Analysis: Method _____ Matrix: _____ Analytes: _____	

Comments:

Sample ID	Date/Time	Sample Location/Description	FOR AIR SAMPLES ONLY				Sample Area or Air Volume
			Type	Time On/Off	Avg. LPM	Total Time	
<u>FV01</u>	<u>12/9/08</u>	<u>Ceiling/wall plaster</u>	A P C				
			A P C				
			A P C				
			A P C				
			A P C				
			A P C				
			A P C				
			A P C				
			A P C				

Sampled by: Leroy Date: 12/9/08 Time: 2:35 pm

Shipped via: Fed Ex Airborne UPS US Mail Courier Drop Off Other:

Relinquished by:	Relinquished by:	Relinquished by:
Date / Time:	Date / Time:	Date / Time:
Received by: <u>OW</u>	Received by:	Received by:
Date / Time: <u>12/11/08 10:00 AM</u>	Date / Time:	Date / Time:
Condition Acceptable? <input checked="" type="checkbox"/> Yes <input type="checkbox"/> No	Condition Acceptable? <input type="checkbox"/> Yes <input type="checkbox"/> No	Condition Acceptable? <input type="checkbox"/> Yes <input type="checkbox"/> No

OW

Fairview Kitchen
High

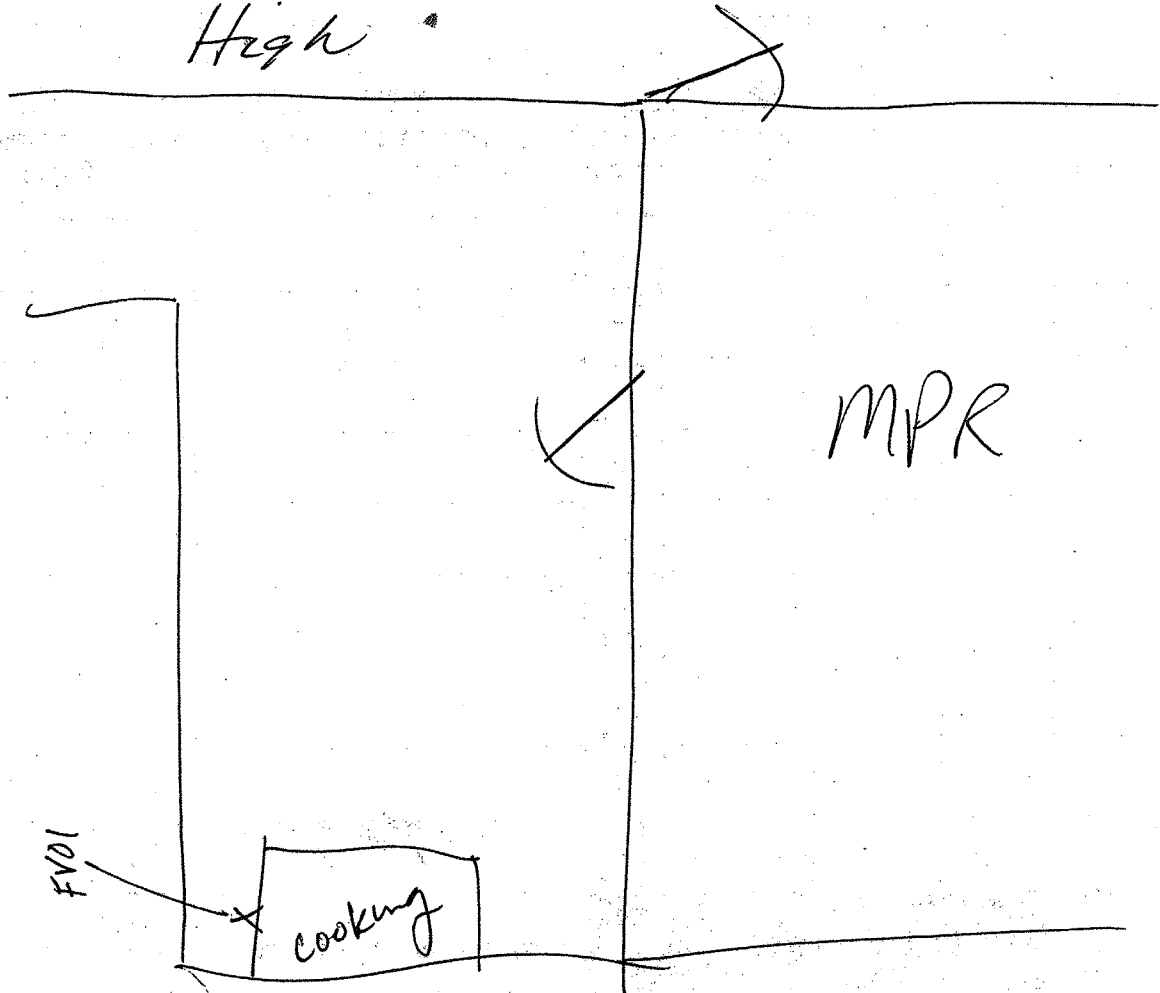



Administrative Offices
1163 E. Seventh Street
Chico, CA 95928-5999

530/898-3000
fax 891-3220
www.cusd.chico.k12.ca.us

Maintenance/Operations/Facilities • 2455 Carmichael Drive • Chico, CA 95928 • (530) 891-3195 • Fax: (530) 891-3190

Fed Ex Airbill #8527 7025 2019

December 9, 2008

Forensic Analytical Specialties, Inc.
3777 Depot Road, Suite 409
Hayward, CA 94545

Re: Fair View High School

To Whom It May Concern:

Please test the enclosed samples from Fair View High School for asbestos. We would like a 48-hour turnaround on the samples. Please e-mail the results as soon as they are available to lchristo@chicousd.org.

Site Sampled:	Fair View High School
Location:	Kitchen Ceiling/Wall Plaster
Date Sampled:	December 9, 2008
Number of Samples:	One – FV01

Thank you for your prompt response to this request.

Sincerely,

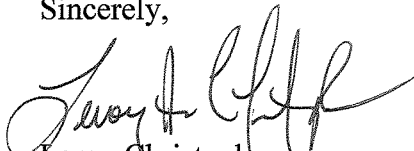
Leroy Christophersen
Safety & Loss Coordinator

Enclosure
dlg